

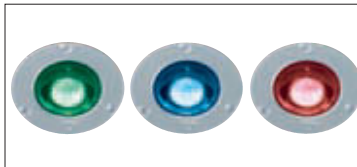

It is advised to install Starled according to the following information.

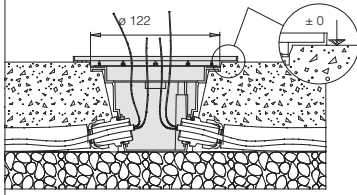

IP67IK08

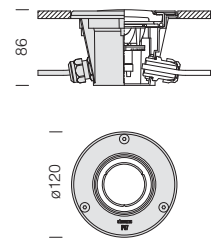

**Housing:** fibreglass nylon with stainless steel AISI 316 frame.

**Diffuser:** tempered shock and heat resistant glass.

**1635 Microfloor - Power LED RGB Fullcolor**

wattage (350mA)	colour	CLD S+L		temperature and load				LED (Ta=25°C)	
		weight	code	W tot	T. max	max load kg	can be walked on	can bear vehicle loads	ølm 350mA
<b>4,5W LED Fullcolor</b>	s. steel	0.40	530800-00	<b>4,5W</b>	40°	2000	ok	ok	105lm

The system offers the possibility to adjust the light beam. Power LED RGB: LEDs with high light density, small light source with multi-colour optics allowing excellent colour mixing performance.

**Example of installation**

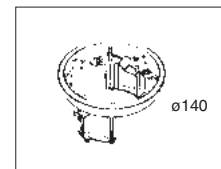
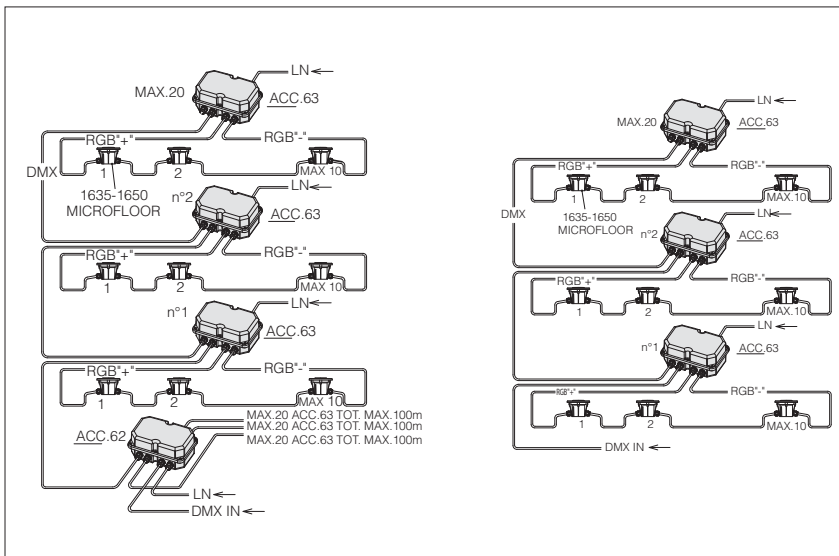

**acc. 314 - chassis**

993926-00

To install Microfloor on the wall.

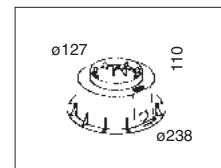

**acc. 313 - outer shell**

993925-00

To install Microfloor into the ground.

**IP65 box for DMX controller**

white	986557-00
-------	-----------

DMX controller with internal memory IP 65 VERSION (stand-alone function). It enables to operate DMX interfaces and integrated DMX controlled lighting fixtures. Option to save settings internally. PC connection through USB port during the programming phase using a dedicated software (included in the kit).

**Acc. 62 DMX signal regenerator**

20W	986513-00
-----	-----------

DMX signal regenerator in waterproof gear box with 24V, 20W power supply. Supplied with in-out wire connection (one going in, four going out) to DMX terminal. To be used after 20 acc. 61 or distance greater than 200mt.

**DMX Controller**

white	986562-00
-------	-----------

DMX controller with internal memory (stand-alone function). It enables to operate DMX interfaces and integrated DMX controlled lighting fixtures. Option to save settings internally. PC connection through USB port during the programming phase through a dedicated software (included in the kit).

**DOP Controller**

	986563-00
--	-----------

DMX controller for installation in standard recessed box, 503. One dmx channel + 4 channels, 1-10V. Option to save settings internally. Monochrome display screen and on-board operation without the use of a PC.



**acc. 65 Remote control LED RGB**

black	986507-00
-------	-----------

On-Off function, mixing and colour transition.

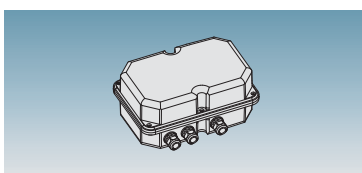

**acc. 61 Waterproof box IP 65**

7W/channel	986512-00
------------	-----------

Waterproof box IP67, supplied with power supply and control module. One box is recommended for use with up to 5 Microfloor/RGB lamps, 7W/channel. Connection for up to 19 Slave devices.

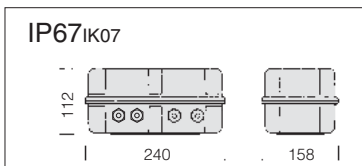

**acc. 63 LED RGB power supply and DMX interface**

60W	986511-00
-----	-----------

IP67 box with 48V 60W power supply for Power LED - max 9 Microfloor Fullcolor. Supplied with electronic card and controller / DMX interface

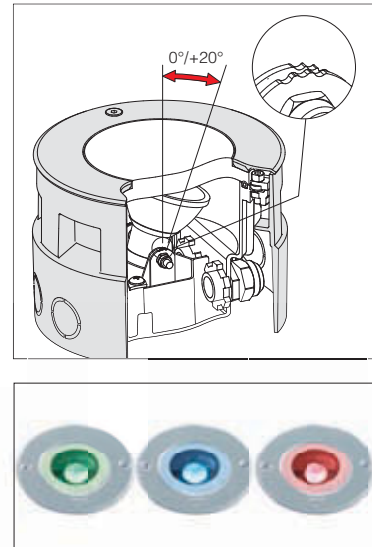
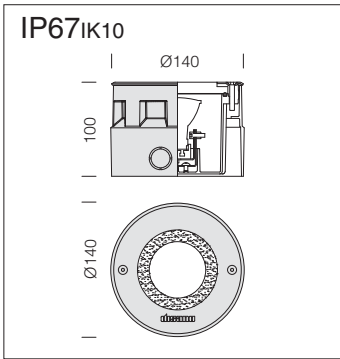

**Housing:** fibreglass nylon with stainless steel AISI 316 frame.

**Diffuser:** tempered shock and heat resistant glass.

**Standard supply:** supplied with power supply cable



1871 Midifloor adjustable - Power LED RGB Fullcolor									
		CLD S+L		temperature and load					LED (Ta=25°C)
wattage (350mA)	colour	weight	code	W tot	T. max	max load kg	can be walked on	can bear vehicle loads	ølm 350mA
4,5W LED Fullcolor	s. steel	0.50	530790-00	4,5W	40°	3000	ok	ok	105lm

The system offers the possibility to adjust the light beam. Power LED RGB: LEDs with high light density, small light source with multi-colour optics allowing excellent colour mixing performance. not suited for underwater installation

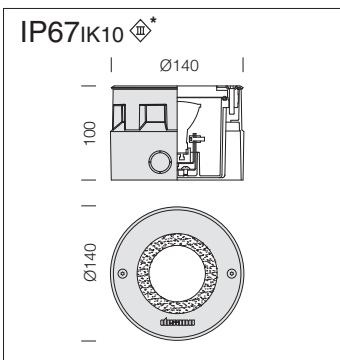

**Housing:** fibreglass nylon with stainless steel AISI 316 frame.

**Diffuser:** tempered shock and heat resistant glass.

**Standard supply:** supplied with power supply cable



1872 Midifloor adjustable										
		CLD S+L		temperature and load					LED (Ta=25°C)	
wattage (350mA)	colour	weight	code	W tot	beam angle	T. max	max load kg	can be walked on	can bear vehicle loads	K - ølm 350mA
MASTERLED 5,5W (230V)	s. steel	0.50	530791-00	5,5W	25	45°	3000	OK	OK	2700 K - 270lm
MASTERLED 4W*	s. steel	0.50	530792-00	4W	25	45°	3000	OK	OK	2700 K - 700cd
LED 10W **	s. steel	0.50	530793-00	10W	25	40°	3000	OK	OK	3000 K - 700lm

\*\* LED 10W: version does not adjustable; also available with a beam angle: 13 °, 28 °, 48 ° and 55 °.

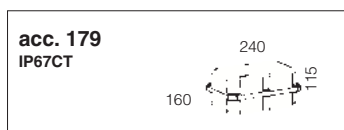

Code	VOLTAGE in	CURRENT V <sub>DC</sub> out	min. no. spotlig.	max no. spotlig.
997661-00	220-240V 50/60Hz	530792-00	1	7
997666-00	220-240V 50/60Hz	530793-00	1	3

Waterproof box containing the ballast.