

Two-colour LED indicator		
<b>Green</b>	Steady light	Standard mode
	Flashing light	Test mode
<b>Red</b>	Assistance	
	1 flash, 4 sec. pause	Battery not connected
	2 flash, 4 sec. pause	Low battery
	3 flash, 4 sec. pause	Battery charger broken
	4 flash, 4 sec. pause	Transformer broken

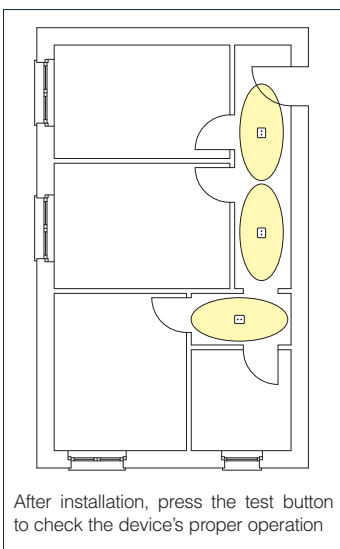

Emergency lighting is an essential safety system to ensure the protection of people during emergency situations. People who are left in the dark during power outages or block-outs, especially in crowded places or during a catastrophic event, will feel uneasy, hence increasing the risk of getting hurt because uneasiness can easily turn into panic. Therefore, an efficient emergency lighting system is an essential requirement to guarantee a safe and fast evacuation during emergencies. If this system is designed in compliance with existing laws and regulations, it will provide the necessary aid that, together with adequate safety signals, will ensure a smooth evacuation from the premises.

Emergency 1 - False-ceiling								
		CLD CELL-E						
wattage/W	colour	weight	code	Input Voltage	Charge duration	Discharge duration	Battery	W tot.
LED	white	1,00	22170918-00	220-240V, 50Hz	24h	1h	7,2V - 800mA	3W
LED	white	1,00	22170919-00	220-240V, 50Hz	24h	3h	7,2V - 1000mA	3W

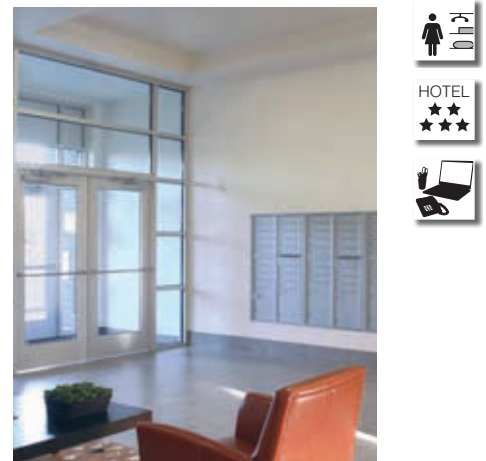
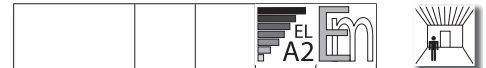
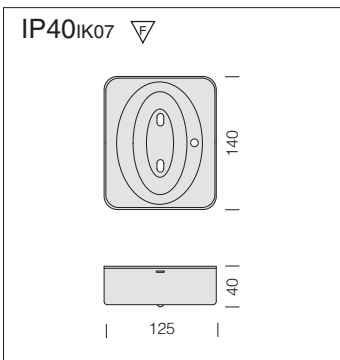

Emergency 2 - Ceiling								
		CLD CELL-E						
wattage/W	colour	weight	code	Input Voltage	Charge duration	Discharge duration	Battery	W tot.
LED	white	1,00	22170818-00	220-240V, 50Hz	24h	1h	7,2V - 800mA	3W
LED	white	1,00	22170819-00	220-240V, 50Hz	24h	3h	7,2V - 1000mA	3W

